

LED DOWN LIGHT SERIES IV(EL-DL4EC)



E-lover LED down light 4EC series state of the art & scientific design with good heat dissipation, low light decay.

With high color rendering index ,high quality Citizen/Cree chips with 50000hrs lifespan, also make sure the stability of the lamp. The shell is made of the high purity aluminum material, performs very good heat dissipation.

Basic Specification

Watt	7W,15W,30W,40W
voltage	AC100-240V 50/60HZ
Beam Angle	120
CRI	80
Application	Airport,Church,Cinema,Gallery,Hospital,Hotel,Kitchen,Meeting Room,Shopping Mall
Material	Aluminum alloy, Glass



Garage



Restaura



Shoppin



Offi



Airp

PRODUCT FEATURES

- Housing material: Aluminum alloy + Glass
- The use of large area cooling structure, good heat dissipation
- High color rendering index.
- No glare, No light pollution.
- Long life span>50,000hrs, 3 years warranty.
- No mercury and lead. No UV. No infrared. No radiation.
- Flickering free.
- CE (TUV) for EMC and LVD approved and RoHS compliant.

PRODUCT DIAGRAM

PRODUCT DIMENSIONS

Part number	Surface [mm]	Height [mm]	Hole size [mm]
EL-DL4EC-7W	89	89	95
EL-DL4EC-15W	115	115	140
EL-DL4EC-30W	145	145	160
EL-D4EC-40W	185	185	205





TECHNICAL DATA

Electrical characteristics¹:

Part number	Input Voltage [Vac]	Frequency [Hz]	Power [W]	Traditional equivalent [W]	Power Factor [%]	Dimmable [Y/N]
EL-DL4EC-7W	AC100-240	50 / 60	7	14	≥0.90	N
EL-DL4EC-15W	AC100-240	50 / 60	15	30	≥0.90	N
EL-DL4EC-30W	AC100-240	50 / 60	30	60	≥0.90	N
EL-D4EC-40W	AC100-240	50 / 60	40	80	≥0.90	N

Note 1: Absolute ratings @ 25°C.

Characteristics¹:

Part number	Color	Color Temperature [°K]	Watts	Lumens [lm]	CRI (Ra)	Beam angle [°]
EL-DL4EC-7W	Warm White	2700-3000K	7W	700	80	120
EL-DL4EC-15W	Warm White	2700-3000K	15W	1500	80	120
EL-DL4EC-30W	Warm White	2700-3000K	30W	3000	80	120
EL-D4EC-40W	Warm White	2700-3000K	40W	4000	80	120

Note 1: Absolute ratings @ 25°C.

Note2: Tolerance of measurement of luminous intensity±15%.

PRODUCT INSTALLATION:

Precaution: Switch off power before doing any works.

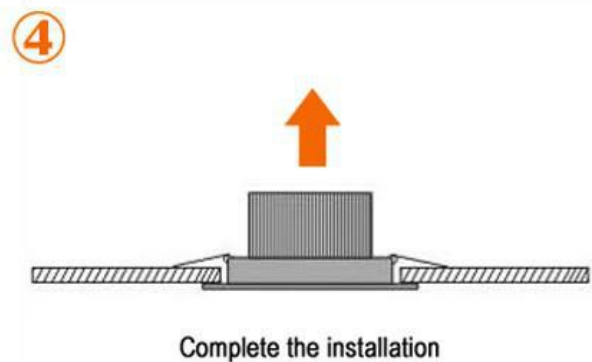
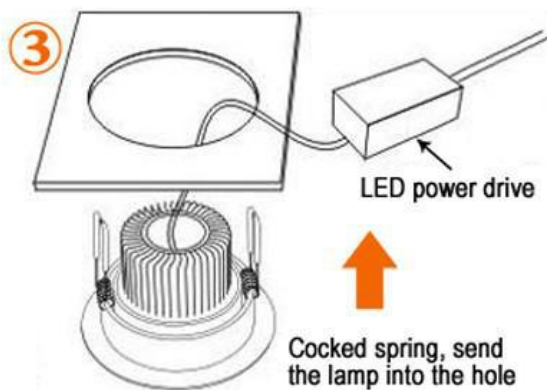
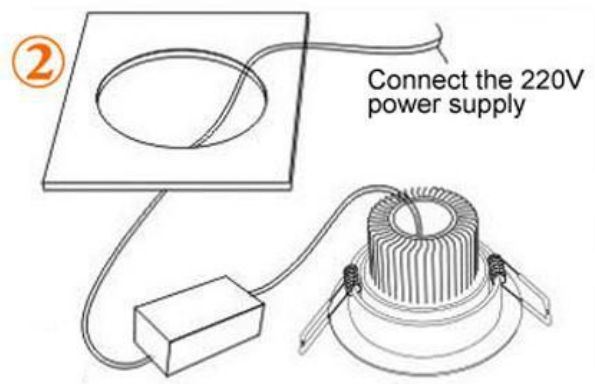
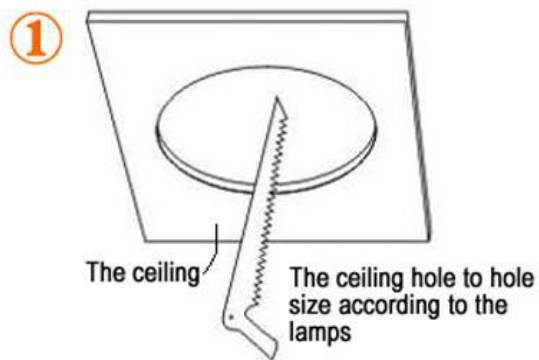

SAFETY



1. Always consult a qualified, licensed electrician prior to the installation of this product.
2. Always ensure that all components are joined properly before they are installed.
3. It is recommended that adequate airflow and heatsink be taken into account in the application and installation of this product. Improper thermal management may lead to premature failure.
4. If any doubt about the installation or use of this product, consult a competent electrician.
5. Exceeding the operating temperature values may damage LED chips by reducing the total lamp life and lumen output, and inversely impact color consistency.
6. Switch off power of the mains supply or respectively of the connection lead before doing any works.
7. Avoid voltage drops by using a dedicated line for each maximum power consumption line .
8. The manufacturer rates each power supply for maximum power output at optimum thermal and voltage conditions. As with any power supply, true actual maximum continuous current output depends upon various environmental factors such as ambient temperature, line voltage fluctuations, and orientation that may affect heat dissipation. For optimum performance, make sure the load is between 50% and 80% of the total capacity of the power supply.
9. LED products are continuously being improved upon in ever-shortening manufacturing cycles. LED color temperature (kelvin), lumen output, and product appearance can change from order to order. Please note that variation in color temperature (kelvin) is commonly +/- 250k and brightness (lumens) is +/- 10%.

Packing

Product Name	Outer Carton Size(L×W×H)[mm]	Qty/Carton [pcs]
EL-DL4EC-7W	580*240*590	50
EL-DL4EC-15W	620*250*660	40
EL-DL4EC-30W	470*470*580	27
EL-D4EC-40W	650*430*760	18

OTHER E-lover PRODUCTS:

For more information about E-lover products, please visit our website www.szeloover.com



DISCLAIMER:

E-lover reserves the right to modify the design of our products as part of the company's program of continuous improvement. E-lover cannot guarantee to match existing installed product for subsequent orders or replace the product exactly to match the product you are replacing in product appearance, color, or brightness. Specifications are subject to change without notice.